

# INSTALLATION INSTRUCTIONS



## Foreman 2.0 LINK Capable Kit

View these instructions online at [www.lbwhite.com](http://www.lbwhite.com)

### Kit Contents:

DESCRIPTION	QTY.
Installation Instructions	1
Power Box w/ Wire Harness	1
Power Box Lid	1
Module	1

KIT NO.	KIT DESCRIPTION
500-134313A	Kit, LINK Capable, Foreman 2.0, 230 Oil & 500/750 DF/Oil
500-134313B	Kit, LINK Capable, Foreman 230 DF 2.0

### Tools required:

1/4 in. socket or Nut Driver  
5/16 in. socket or Nut Driver  
Standard Screwdriver  
3/16 Allan Wrench  
Measuring Tape or Ruler

### Qualifications for installation of the kit:

- You must be able to read and understand these instructions before beginning the installation.
- You must be properly trained and have sufficient experience in servicing forced air heaters and capable of testing the heater for proper operation.

### General information:

- The following instructions provide information on the installation of the LINK power box and the module on a Foreman 2.0 LINK capable model.
- The module must not enter areas where it is prohibited to operate wireless phones or when doing so may cause interference or danger.
- The module cannot be turned off after installation as the device periodically turns on the transmitter to perform tracking reporting.

### Safety Instructions:

- Close all gas valves to the heater.
- Allow the heater to cool down or in cold condition before beginning installation.
- Disconnect the heater from its electrical supply.
- Ensure all screws are securely tightened.



### SCAN THIS

with your smartphone or  
visit <http://goo.gl/5j21G>  
to view maintenance  
videos for L.B. White heaters.\*

*\* Requires an app like QR Droid  
for Android or for iPhone*

**WORLD PROVIDER - INNOVATIVE CLIMATE SOLUTIONS**

411 Mason Street, Onalaska, WI 54650 • 800-345-7200 • 608-783-5691 • 608-783-6115 (fax) • [www.lbwhite.com](http://www.lbwhite.com)

## Initial Preparation:

1. Remove the rear air inlet panel by unscrewing the screws securing it to the heater. See Fig. 1.

**FIG. 1**

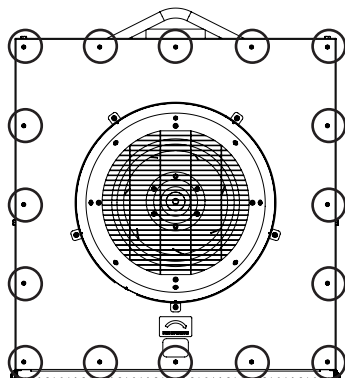

2. Pull the rear panel away from the heater.
3. Locate the fan wheel hub.
4. Using a 3/16 Allen wrench, loosen one of the Allen screws halfway out of the fan wheel hub.
5. Remove the other Allen screw and insert it into the hub removal threaded hole. See Fig. 2.

**FIG. 2**



6. Tighten the Allen screw in the hub removal threaded hole to loosen the fan wheel hub from the motor shaft.

7. Pull the fan wheel off the motor shaft.

- Foreman 500/750 2.0, take caution not to lose the motor shaft key during the fan wheel removal.

## Installation:

1. Locate the LINK power box mounting holes under the motor mount stand. See Fig. 3.

**FIG. 3**

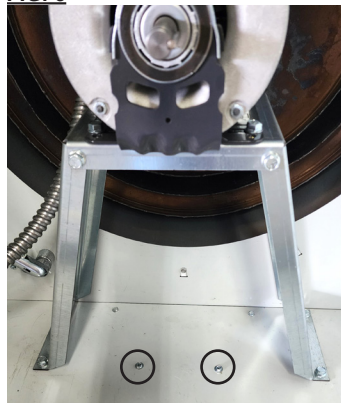

2. Remove the screws and washers.
3. Mount the LINK power box using the screws and washers removed in the previous step as shown in Fig. 4.

**FIG. 4**

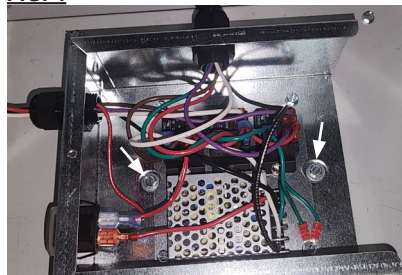

4. Secure the module to the mounting bracket and install the control box lid as shown in Fig. 5.

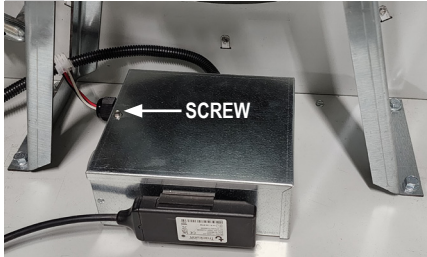
**FIG. 5**

5. Remove the electrical enclosure lid. See Fig. 6.

**FIG. 6**

6. Knock out the 1/2 in. knockout on the base of the electrical box.
7. Remove the nut from the module harness liquid-tight connector and insert the liquid-tight connector through the knockout hole. See Fig. 7.

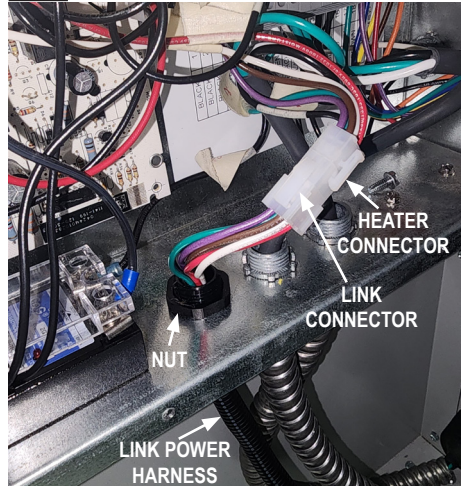
**FIG. 7**

8. Tighten the liquid-tight connector with the nut removed earlier and connect the LINK connector to the heater harness connector as shown in Fig. 7.
9. Install the lid back onto the electrical enclosure.
10. Connect the LINK module connector to the power box connector as shown in Fig. 8.

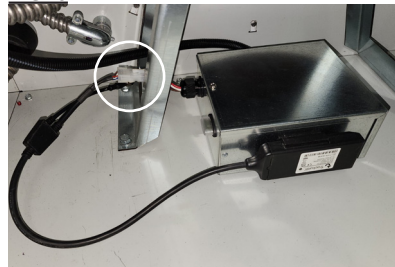
**FIG. 8**

## Completion:

1. Install the fan wheel onto the motor shaft.
  - Foreman 230: Motor shaft extend beyond fan wheel hub, 3/16 inches.
  - Foreman 500/750: Fan wheel hub is flush with motor shaft.
2. Remove the Allen screw from the hub removal thread hole and insert it into the unoccupied thread hole.
3. Align the hub as described in step 1 and securely tighten both Allen screws.
4. Install the rear door and secure it with the screws removed earlier.
5. Connect the heater to its electrical and gas supply.
6. Start the heater and inspect it to ensure normal operation.

### TRACKUNIT SPECIFICATION

Standby time on the backup-battery	2-4 days
Charging time from an empty backup-battery	3 hrs. @ 77°F (25°C)
Expected lifetime of the backup-battery	3 yrs.
Environmental class	IP68

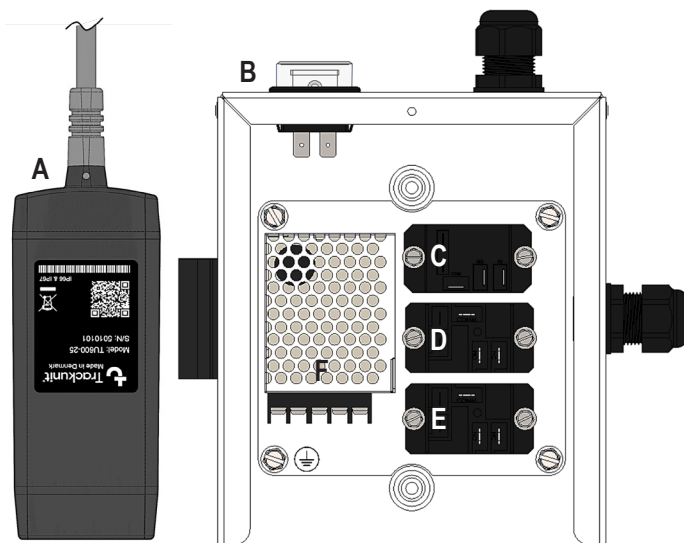

ITEM NO.	DESCRIPTION	500-134313A	500-134313B
A	Module	500-133950	
B	FUSE, 32V, 2A, FAS	574278	
C	RELAY, SPDT	574253	
D	RELAY, SPDT	574253	
E	RELAY, SPDT	574253	574255
F	POWER SUPPLY, 120VAC/12VDC	574244	

## Service

Contact your local L.B. White dealer for replacement parts and service. You may also call the L.B. White Company, LLC at U.S. & Canada: 1-800-345-7200, Overseas: 001-608-783-5691 assistance, or email us at [customerservice@lbwhite.com](mailto:customerservice@lbwhite.com).

Be sure that you have your heater model number or serial number when calling.



**WORLD PROVIDER - INNOVATIVE  
CLIMATE SOLUTIONS**

411 Mason Street, Onalaska, WI 54650  
800-345-7200 • 608-783-5691  
608-783-6115 (fax)

**[www.lbwhite.com](http://www.lbwhite.com)**

150-134329 REV.A