

ASSEMBLY and INSTALLATION INSTRUCTIONS



Gas Conversion Kit Oval 80 Tube Heaters

View these instructions online at www.lbwhite.com

Kit Contents:

DESCRIPTION	QTY.
Instructions	1
Burner orifice	1
Conversion documentation label	1
Gas control valve w/ manifold pipe	1
Pipe thread compound	1

Tools required:

Pipe wrench
Ratchet
3/8 socket
9/16 socket
11/16 socket
Philip screwdriver
1/4 nut driver

Requirements:

- You must read and understand these instructions before beginning the conversion.
- You must be properly trained and have sufficient experience to install the gas conversion kit and test the heater for proper operation.
- Ensure the installation's gas type and pressure conform to the gas type and pressure requirements given in the table below.
- Ensure piping is of appropriate size for gas flow capacity.

	Max. Inlet Pressure	Min. Inlet Pressure
LP Gas	13.5" w.c.	11.0" w.c.
Natural Gas	13.5" w.c.	7.0" w.c.

Discussion:

The following instructions are common for use when converting fuel gas for single stage and two stage tube heaters. Where appropriate, specific instructions pertaining only to two stage heaters will be identified. These instructions pertain to only "B" design Oval 80 tube heaters. Refer to the dataplate on the burner box to determine design sequence (design sequence is the FIRST letter in the configuration number). If unsure, call L.B. White Company.

General Instructions:

- Close the main gas supply valve to the heater, and disconnect the heater's gas hose from the sediment trap.
- Disconnect the heater's electrical supply.
- For reassembly, reverse the respective service procedure.
- Use pipe thread compound at all threaded connections.
- Ensure all threaded connections are tightened securely.

Removing the Burning Orifice

1. Remove the igniter mounting screws and the igniter from the heater. **DO NOT FORCE OR BEND THE IGNITER DURING REMOVAL PROCESS.** See Fig. 1 & Fig. 2.

FIG. 1

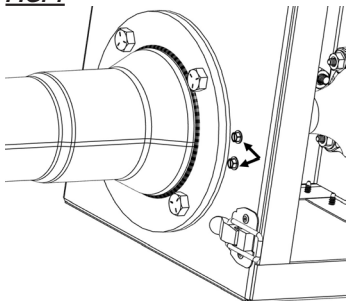
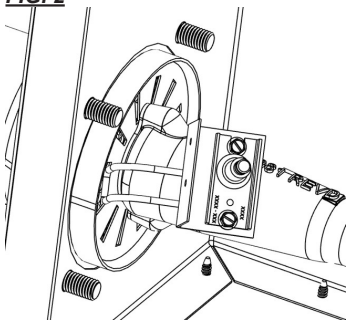
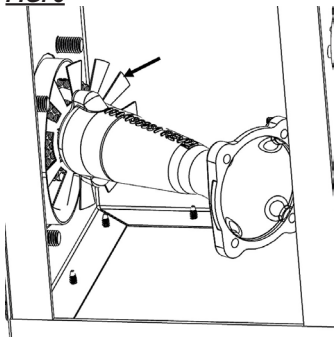

FIG. 2



2. Disconnect the pressure switch tube from the copper tube.
3. Remove the four nuts securing the burning casting and remove the burner casting from the heater. Save the nuts to be use later. See Fig. 3. **Do not force or bend vanes on burner vane plate during removal process.**

FIG. 3

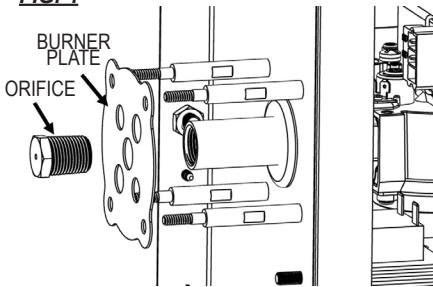

4. Remove the orifice and burner plate. see Fig. 4.

FIG. 4

Removal of the Gas Control Assembly

1. Remove the screws securing the valve assembly to the burner box. See FIG. 5

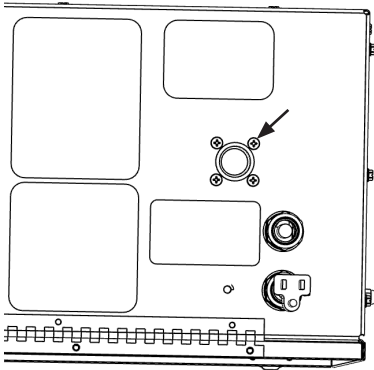
FIG. 5

2. Remove the gas valve and pipe assembly out.
3. Take care not to remove the center partition grommet when removing the gas valve assembly.

Installing New Gas Train

1. Install the gas train from conversion kit.
2. Take care not to push the grommet through the center partition when install the new valve assembly.
3. Secure the gas valve to the case with screws removed earlier.

Installing Orifice and Burner Casting

1. Insert the burner plate onto the four burner casting bolts.
2. Install the orifice from the conversion through the burner plate onto the pipe nipple.
3. Tighten the orifice securely .
4. Install the burner onto the four bolts.
5. Secure the burner with previous removed nuts. See FIG. 6.

FIG. 6

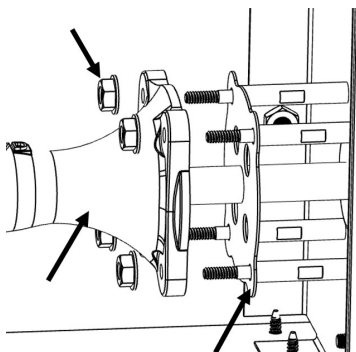

6. Ensure the ignitor opening of the burner vane is directed down toward the ignitor mounting screw holes. See Fig. 7.

FIG. 7

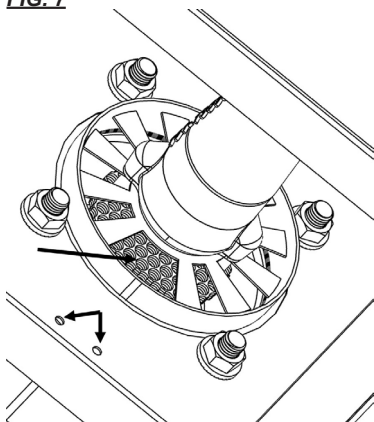

7. Install the rubber hose from the pressure switch to the copper tube.
8. Install the ignitor. Pivot ignitor as necessary to ensure ignitor is properly positioned.
Secure with screws removed earlier. **Do not force or bend the ignitor during installation process.**
9. Attached the previous removed sediment trap to the heater inlet.

Completion

1. Apply the conversion documentation label from the kit near the dataplate label.
2. Enter the information as required on the conversion documentation label.
3. Close and latch the burner box panel.
4. Attach the supply air flex tube onto the heater.
5. Open the heater main gas supply valve.
6. Start the heater and check for proper operation.

Service

Contact your local L.B. White dealer for replacement parts and service. You may also call the L.B. White Co., LLC at 1-800-345-7200, for assistance, or email us at customerservice@lbwhite.com.

Be sure that you have your heater model number and configuration number when calling.



**WORLD PROVIDER - INNOVATIVE
HEATING SOLUTIONS**

411 Mason Street, Onalaska, WI 54650
800-345-7200 • 608-783-5691
608-783-6115 (fax)

www.lbwhite.com