



SERVICE BULLETIN

Guardian 250 2.0 Pilot

Missing Pilot Bracket/Gasket

Products:

Guardian 250 2.0 Pilot

Product Issue:

Potential heaters with serial no. L000678958 Through L000679107 missing pilot bracket/gasket

Corrective Action:

Contact your local dealer and order kit 574312. This will be a warranty replacement at no charge to the customer.

Labor:

The installation of the pilot bracket/gasket should require less than 5 minutes.

Tools Needed:

1/4 in. socket
Ratchet or Cordless Drill
Phillips Screwdriver

Preparation:

Confirm the pilot bracket/gasket is missing from your pilot assembly. The burner end door can be removed for easier access to the components.

- Remove the left side burner casting screw and spacer.
- Pull the pilot assembly away from the burner cast and remove the two Phillip screws securing the pilot shield to the pilot assembly.
- Lift the pilot shield to see if the pilot bracket/gasket are missing. See figure below.

- If the pilot bracket/gasket is present, no other service is required. Reassemble the pilot assembly and secure it back to the burner casting.
- If the pilot bracket/gasket is missing, contact your local L.B. White dealer and order service kit 574312. For installation instructions, see back page.

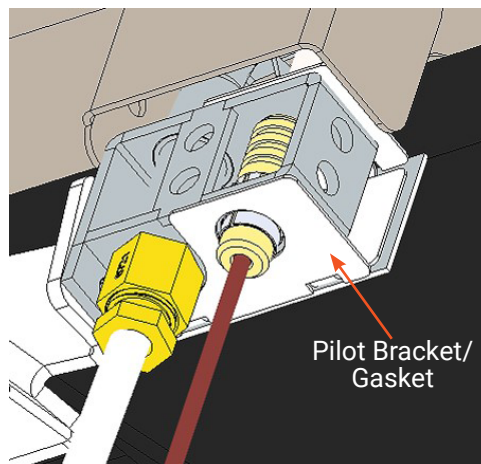
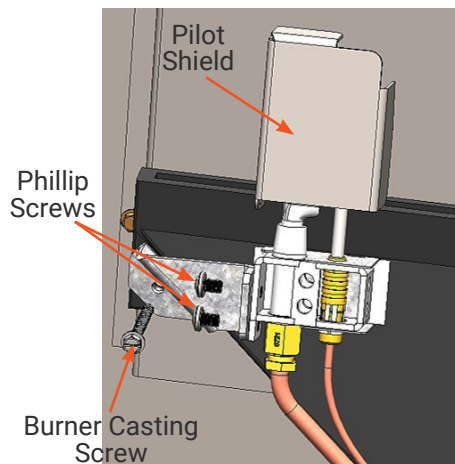
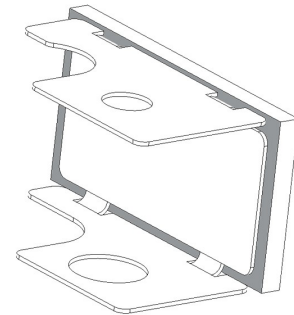



SERVICE BULLETIN

Guardian 250 2.0 Pilot Missing Pilot Bracket/Gasket

Installation Instructions:

The following instructions are for units missing the pilot bracket/gasket.

1. The following instructions are to be proceed after the preparation instructions.
2. Pull the thermocouple down.
3. Insert the pilot bracket/gasket onto the back of the pilot orifice bracket as shown in FIG. 1.
4. Insert the thermocouple back into the pilot orifice bracket. Ensure it is fully inserted in the pilot orifice bracket.
5. Install the pilot shield onto the pilot orifice assembly with the two previous removed Phillip screws.
6. Position the pilot assembly up against the burner casting and secure the burner bracket to the casting with the previously remove screw and spacer.
7. Open all gas supply valves to the heater and start the heater for normal operation.

FIG 1:

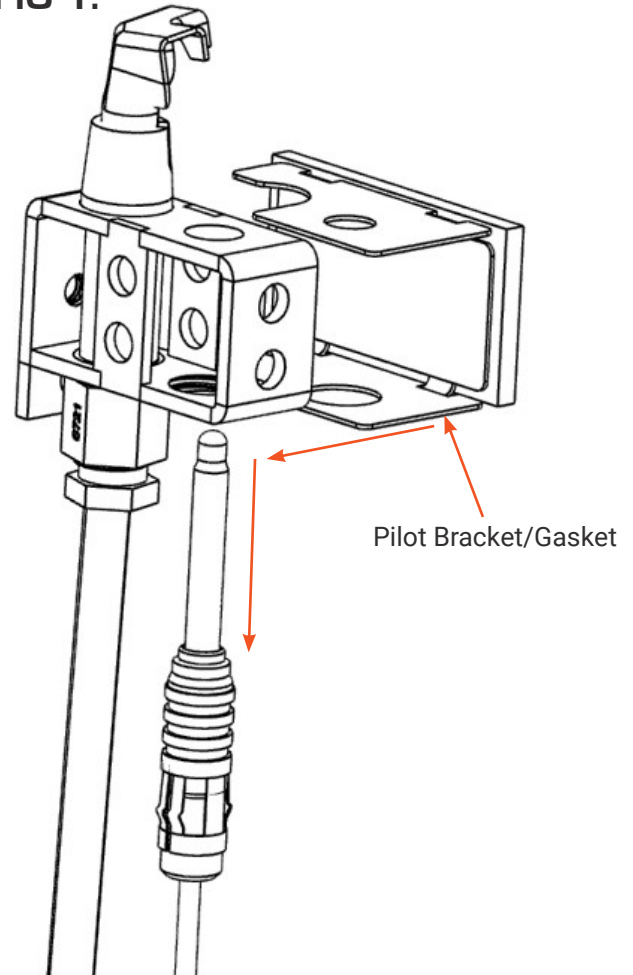

Service Videos:

The Guardian 250 2.0 pilot bracket/gasket service videos are available for reference along with many other products at www.lbwhite.com.

