

INSTALLATION INSTRUCTIONS



16 in. Duct Adapter FOREMAN 500/750 JOURNEYMAN 360

View these instructions online at www.lbwhite.com

Kit Contents:

DESCRIPTION	QTY.
Instruction, Installation	1
Duct Adapter	1
Bolt, Cap, Hex Flange, 5/16-18	1
Plug, Button	1
*Bracket, Mount, Journeyman 360	1
Nut, Lock Hex Flange, 5/16-18	1

* To be used on the Journeyman heater ONLY

Kit: 500-30902

Tools required:

- 1/2 in. nut driver or wrench
- 3/8 in. nut driver or wrench

Qualifications for installation of the kit:

- You must be able to read and understand these instructions.
- You must be properly trained and have sufficient experience in servicing heaters and capable of testing the heater for proper operation.

General Information

- The following instructions provide information for connecting a 2 to 1 duct adapter to either the Foreman or Journeyman indirect fired heater.
- Not all kit contents may be used.



WARNING

Burn Hazard

- Heater surfaces are hot for a period of time after the heater has been shut down.
- Allow the heater to cool before performing service, maintenance, or cleaning.
- Failure to follow this warning will result in burns causing injury.

Preparation

- For Foreman heater, remove the bolt and nut from the duct adapter. Save them to be used later. See Fig.1.
- For Journeyman heater, remove the bolt, nut, and plug from the duct adapter.
 - Plug the bolt hole from the inside with the previous removed plug button.
 - Save the bolt and nut to be use later.

FIG. 1

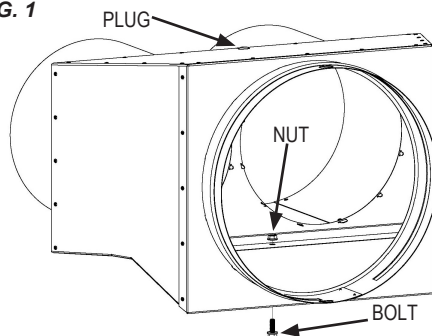

- For Foreman 500/750 installation, see page 2.
- For Journeyman 360 installation, see page 3.

Foreman Installation:

1. Slide the two round tubes of the duct adapters onto the heater 12 in. outlets. See Fig. 2.

FIG. 2

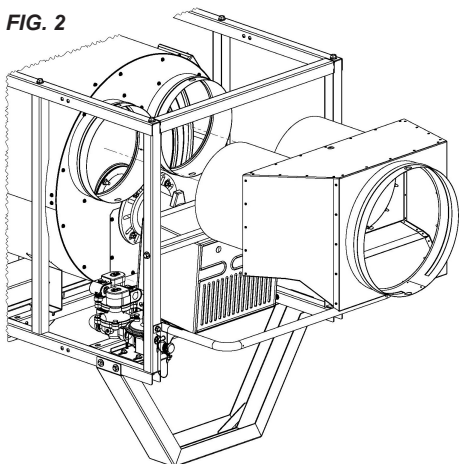

2. Align the duct adapter mounting hole with the heater frame as shown in Fig. 3.

FIG. 3

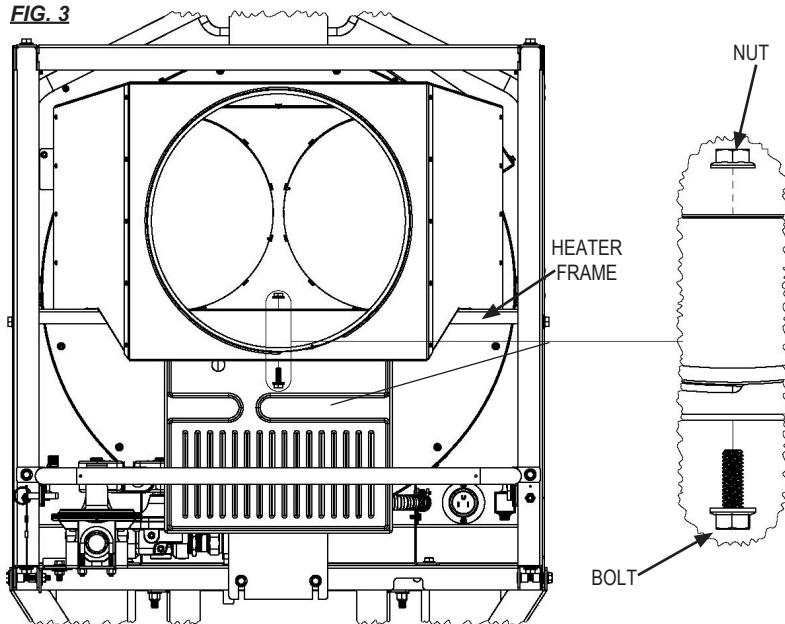

3. Tighten the bolt and nut to secure the duct adapter to the heater frame.
4. Attach and secure the 16 in. duct to the adapter outlet.

NOTE: The duct length depends on the heater air flow restriction. The lesser the restriction (less bends) the longer the duct run. If you are experiencing frequent high limit tripping, reducing the duct length or straightening the duct will be required.

NOTE: When installing the duct adapter to the Foreman heater, discard the provided mounting bracket.

Journeyman Installation:

1. Remove the bolt as shown in FIG. 4.
2. Slide the two round tubes of the duct adapters onto the heater 12 in. outlets. See Fig. 4.

FIG. 4

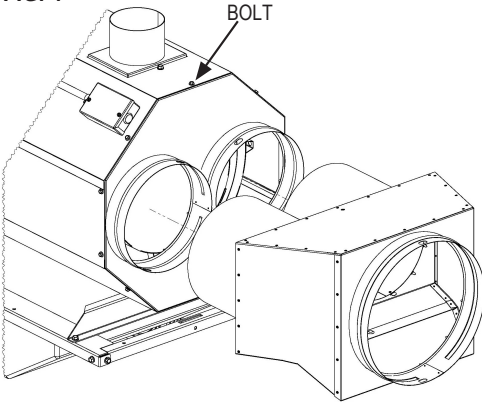

- Secure the duct adapter to the heater with the mounting bracket as shown in Fig. 5.

FIG. 5

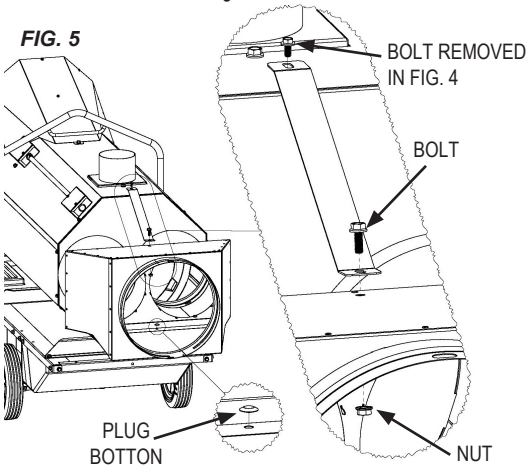

4. Tighten the bolt and nut to secure the duct adapter to the heater frame.
5. Attach and secure the 16 in. duct to the adapter outlet.

NOTE: The duct length depends on the heater air flow restriction. The lesser the restriction (less bends) the longer the duct run. If you are experiencing frequent high limit tripping, reducing the duct length or straightening the duct will be required.

Service

Contact your local L.B. White dealer for replacement parts and service. You may also call the L.B. White Co., Inc. at 1-800-345-7200, for assistance, or email us at customerservice@lbwhite.com.

Be sure that you have your heater model number and configuration number when calling.



**WORLD PROVIDER - INNOVATIVE
HEATING SOLUTIONS**

411 Mason Street, Onalaska, WI 54650
800-345-7200 • 608-783-5691
608-783-6115 (fax)

www.lbwhite.com

150-130979 REV.C