

INSTALLATION INSTRUCTIONS



Premier Door Hinge Pin Kit

View these instructions online at www.lbwhite.com

Kit Contents:

Premier CS/TS170 Kit-574634

DESCRIPTION	QTY.
Instruction, Installation	1
Hinge Pin-27.625" Louvered Door	1
Hinge Pin-23.125" Solid Door	1

Tools required:

- Flat-head Screwdriver
- Hammer
- Pliers
- Drill
- 1/8" Drill Bit
- 1/4" Hex Bit

Premier CS/TS350 Kit-574635

DESCRIPTION	QTY.
Instruction, Installation	1
Hinge Pin 27.625"	2

Premier CS700 Kit-574636

DESCRIPTION	QTY.
Instruction, Installation	1
Hinge Pin 31.375"	2

Qualifications for installation:

- You must be able to read and understand these instructions.

Preparation:

- Shut off the gas supply to the heater.
- Unplug the heater from its electrical source.

Installation:

1. Using a flat-head screwdriver, open the solid and louvered doors. (Note: The Premier 700 model is equipped with two solid doors.)
2. Using the flat-head screwdriver apply up-word pressure depressing the spring clip and remove the top of the door. (Refer to Fig. 1.)
3. Once the top of the door is disengaged from the spring clip, remove the door.
4. Use pliers to securely grip the bottom hinge pin. Apply upward force and remove the pin. (Refer to Fig. 1.)

FIG. 1

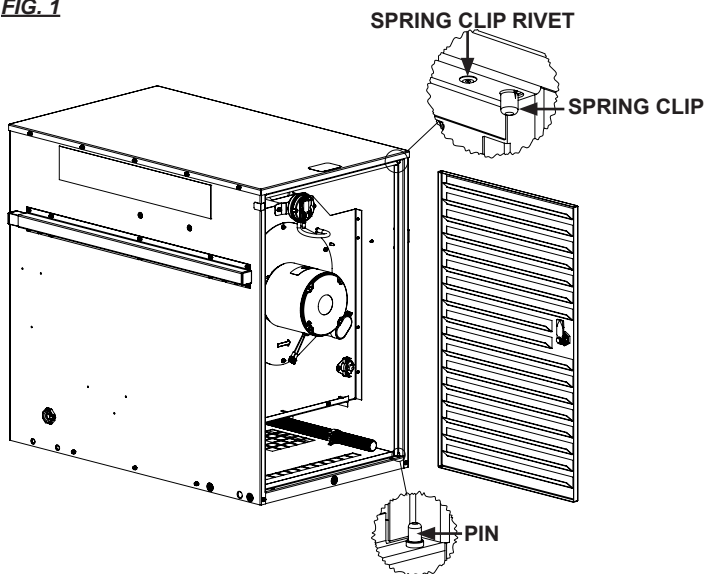

5. Use the drill equipped with the 1/8" drill bit and remove the rivets mounting the spring clips to the top and dis-guard the clips. (Refer to Fig. 1.)

Note for Premier 700: This model features a fixed center divider between the upper and lower heater compartments. After drilling, the spring clip may remain lodged within the internal bracket and cannot be fully removed. (Refer to Fig. 2.)

FIG. 2

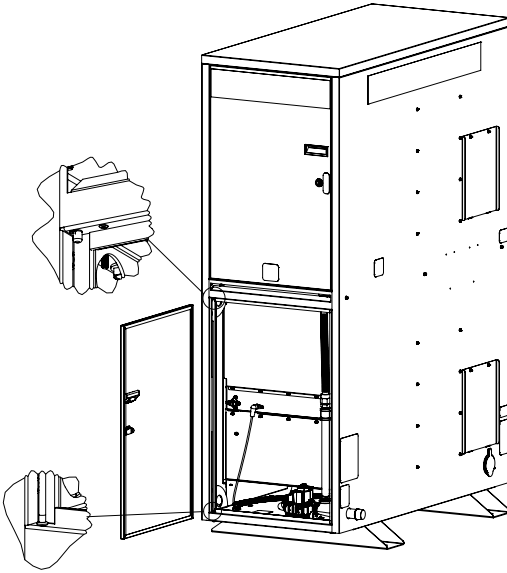

6. After removing both spring clips, use a drill with a 1/4" hex head bit to extract all screws securing the top panel to the heater assembly. (For Premier 170, refer to Fig. 3.)

FIG. 3

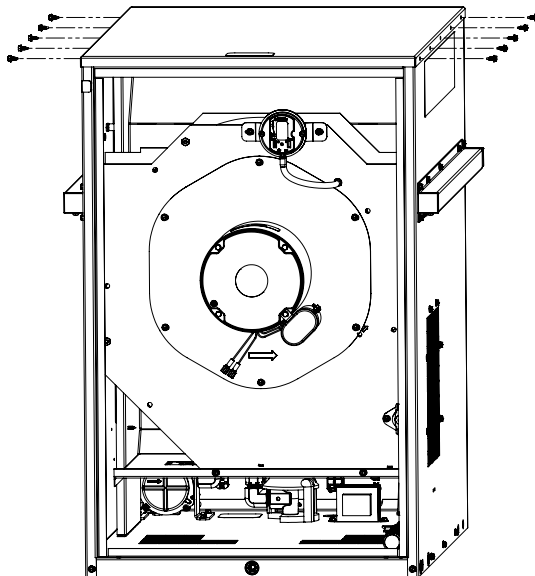

(The Premier 350 will have 2 extra screws mounting the bottom of the control panel that will need to be removed on the louver door side. See Fig. 4.)

FIG. 4

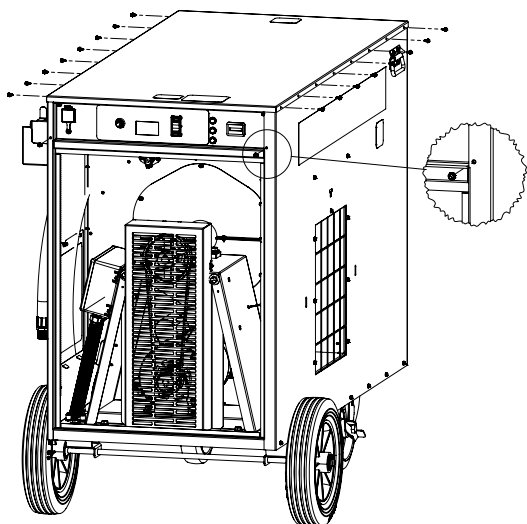

(The 700 has a bracket between the top and bottom heater. That will stay in place. The 2 top cover screws will need to be removed. See Fig. 5.)

FIG. 5

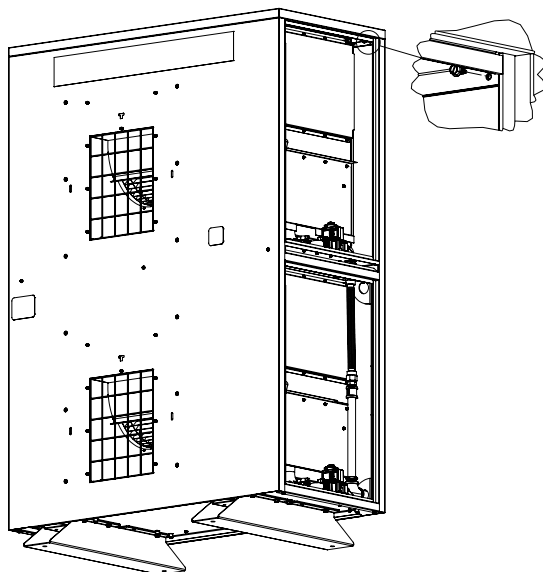

7. Grabbing the correct hinge pin, slide the bottom of the pin through the bottom hole of the door into the top.

8. For the Premier 170 and 350 models, place the bottom of the door with the hinge pin in the location of the pin we removed. Using a hammer tap the top of the hinge pin down. Slightly lift the top panel, and insert the top of the hinge pin into the hole created by the removal of the spring clip. (Refer to Fig. 6 for Premier 170.) For the Premier 350, refer to Fig. 7.

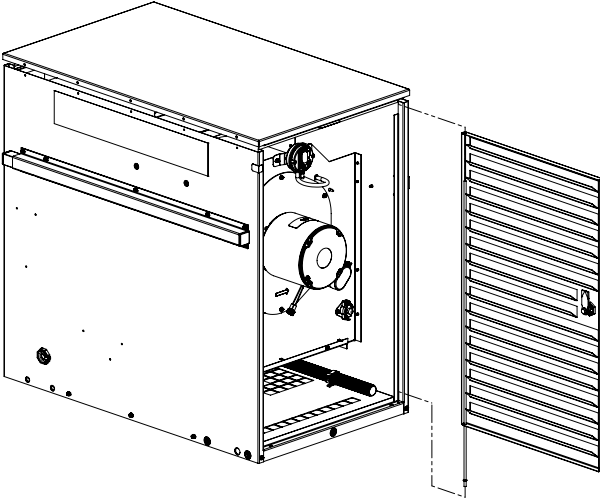
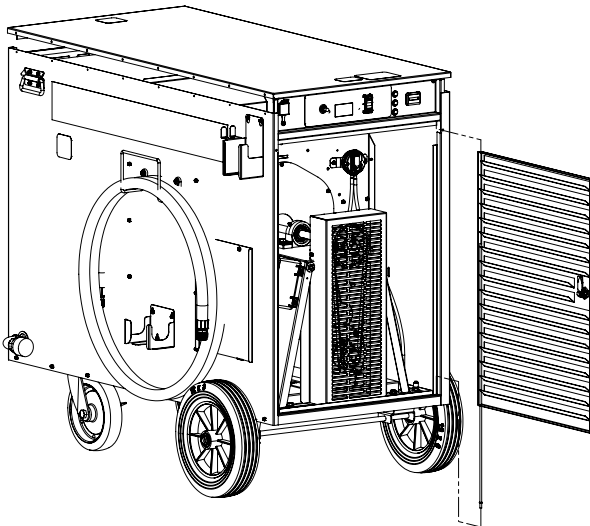
FIG. 6**FIG. 7**

When installing the kit on the Premier 700, position the bottom door onto the pin. Place the pin into the location we removed the pin from. With the hammer tap that pin down. Grasp the center of the pin. You might have to use screwdriver to pull the pin outward until it can be grasped by hand. Continue pulling the pin, bending it as needed, until it aligns with the hole left by the removal of the spring clip at the top.

Allow the bowed pin to release, locking the hinge pin into its final position. (Refer to Fig. 8.)

FIG. 8

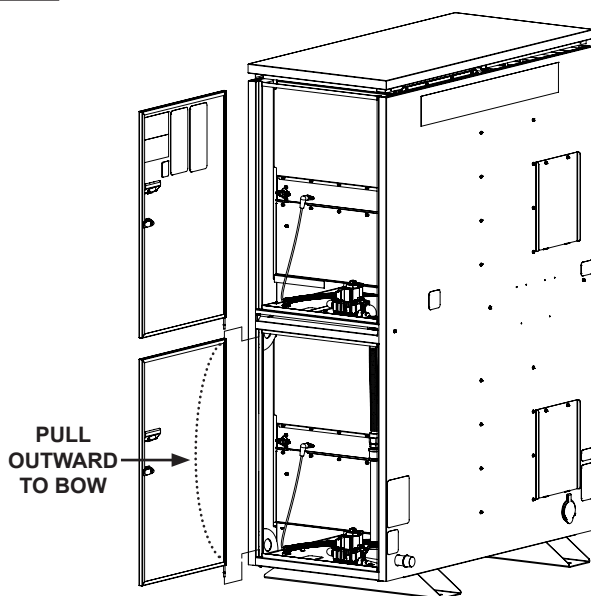

9. After both doors are installed, proceed to reinstall the screws securing the top panel to the heater and ensure both doors are latched properly.

Notes:

Service

Contact your local L.B. White dealer for replacement parts and service. You may also call the L.B. White Co., LLC at U.S. & Canada: 1-800-345-7200, Overseas: 001-608-783-5691 assistance, or email us at customerservice@lbwhite.com.

Be sure that you have either the heater model or serial number when calling.



**WORLD PROVIDER - INNOVATIVE
CLIMATE SOLUTIONS**

411 Mason Street, Onalaska, WI 54650
800-345-7200 • 608-783-5691
608-783-6115 (fax)

www.lbwhite.com